

## Embranchements 45° HDPE, fiche technique

### Embranchements égaux en PE-dur, avec emboîtements et joints

Conformes aux normes : EN 12666 - R 592012 - Qplus 11004 - SKZ-Ü

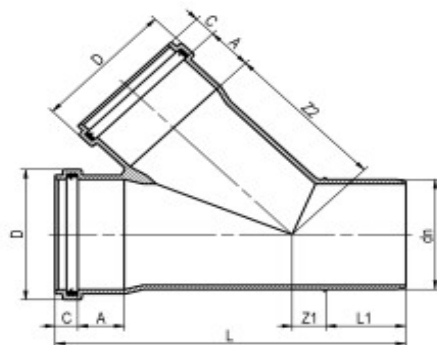

<sup>1</sup> S12,5

\* Pièce façonnée

**SN2 / SDR33 / S16 - SN4 / S12.5 / SDR26** Couleur noir

dn	dn	D	C	A	L1	Z1	Z2	L	Poids	Cart.	Pal.	Article
mm	mm	mm	mm	mm	mm	mm	mm	mm	kg	P.	P.	N°
<sup>1</sup> 110	110	138.4	24.7	83.9	117.5	29.4	152.4	408	1.019	14	56	S16PEEYC110110
<sup>1</sup> 125	125	153.8	24.7	85.0	121.0	30.5	168.8	430	1.578	12	48	S16PEEYC125125
<sup>1</sup> 160	160	199.4	31.0	89.0	134.0	41.7	217.9	515	2.696	5	20	S16PEEYC160160
200	200	231.9	36.7	93.0	143.0	48.0	271.3	592	3.780	4	16	S16PEEY200200
*250	250	293.0	56.0	97.0	200.0	112.0	524.0	925	13.200			S16PEEY250250
*315	315	363.6	63.0	104.0	200.0	154.0	586.0	1075	23.300			S16PEEY315315
*355	355	406.0	59.0	221.0	280.0	84.0	570.0	1150	24.500			S16PEEY355355
*400	400	433.9	71.0	118.0	280.0	93.0	730.0	1200	32.500			S16PEEY400400

Autres dimensions sur demande

Valeurs indicatives, informatives et non contractuelles.

## Embranchements 45° HDPE, fiche technique

### Embranchements réduits en PE-dur, avec emboîtements et joints

Conformes aux normes : EN 12666 - R 592012 - Qplus 11004 - SKZ-Ü

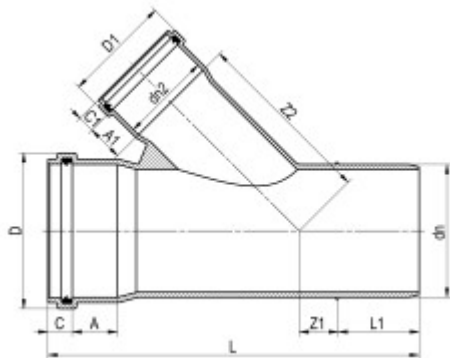

<sup>1</sup> S12,5

\* Pièce façonnée

**SN2 / SDR33 / S16 - SN4 / S12.5 / SDR26** Couleur noir

dn mm	dn2 mm	D mm	C mm	A mm	D1 mm	C1 mm	A1 mm	L1 mm	Z1 mm	Z2 mm	L mm	Poids kg	Cart. P.	Pal. P.	Article N°
<sup>1</sup> 125	110	153.8	24.7	85.0	138.4	24.7	83.9	121.0	30.5	164.5	430	1.480	12	48	S16PEEYC125110
<sup>1</sup> 160	110	199.4	31.0	89.0	138.4	24.7	83.9	134.0	41.7	201.3	515	2.454	6	24	S16PEEYC160110
<sup>1</sup> 160	125	199.4	31.0	89.0	153.8	24.7	85.0	134.0	41.7	216.0	515	2.350	6	24	S16PEEYC160125
200	110	231.9	36.7	93.0	138.4	24.7	83.9	143.0	48.0	251.8	592	3.180	4	16	S16PEEY200110
200	125	231.9	36.7	93.0	153.8	24.7	85.0	143.0	48.0	252.3	592	3.210	4	16	S16PEEY200125
200	160	231.9	36.7	93.0	199.4	31.0	89.0	143.0	48.0	275.0	592	3.630	4	16	S16PEEY200160
*250	110	293.0	56.0	97.0	138.4	24.7	83.9	200.0	60.0	375.0	802	7.900			S16PEEY250110
*250	125	293.0	56.0	97.0	153.8	24.7	85.0	200.0	71.0	375.0	825	7.900			S16PEEY250125
*250	160	293.0	56.0	97.0	199.4	31.0	89.0	200.0	95.0	383.0	870	9.600			S16PEEY250160
*250	200	293.0	56.0	97.0	231.9	36.7	93.0	200.0	127.0	415.0	930	10.300			S16PEEY250200
*315	110	363.6	63.0	104.0	138.4	24.7	83.9	200.0	80.0	418.0	890	12.000			S16PEEY315110
*315	125	363.6	63.0	104.0	153.8	24.7	85.0	200.0	91.0	418.0	910	13.200			S16PEEY315125
*315	160	363.6	63.0	104.0	199.4	31.0	89.0	200.0	315.0	427.0	960	14.100			S16PEEY315160
*315	200	363.6	63.0	104.0	231.9	36.7	93.0	200.0	140.0	467.0	1015	15.400			S16PEEY315200
*315	250	363.6	63.0	104.0	293.0	56.0	97.0	200.0	180.0	485.0	1088	20.200			S16PEEY315250
*355	160	406.0	59.0	221.0	199.4	31.0	89.0	280.0	0.0	458.0	962	17.800			S16PEEY355160
*355	200	406.0	59.0	221.0	231.9	36.7	93.0	280.0	25.0	490.0	1015	19.300			S16PEEY355200
*400	160	433.9	71.0	118.0	199.4	31.0	89.0	280.0	0.0	488.0	953	20.800			S16PEEY400160
*400	200	433.9	71.0	118.0	231.9	36.7	93.0	280.0	8.0	525.0	1010	22.300			S16PEEY400200

Autres dimensions sur demande

Valeurs indicatives, informatives et non contractuelles.

## Embranchements 90° HDPE, fiche technique

### Embranchements en PE-dur, avec emboîtements et joints

Conformes aux normes : EN 12666 - R 592012 - Qplus 11004 - SKZ-Ü

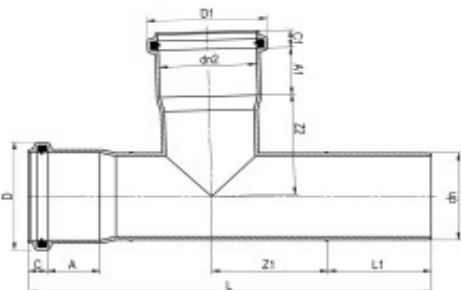

<sup>1</sup> S12,5

\* Pièce façonnée

**SN2 / SDR33 / S16 - SN4 / S12.5 / SDR26** Couleur noir

dn mm	dn2 mm	D mm	C mm	A mm	D1 mm	C1 mm	A1 mm	L1 mm	Z1 mm	Z2 mm	L mm	Poids kg	Cart. P.	Pal. P.	Article N°
<sup>1</sup> *110	110	138.4	24.7	83.9	138.4	24.7	83.9	117.5	317.5	139.4	683	1.400			S16PEET110110
<sup>1</sup> *125	110	153.8	24.7	85.0	138.4	24.7	83.9	121.0	329.0	149.4	713	1.800			S16PEET125110
<sup>1</sup> *125	125	153.8	24.7	85.0	153.8	24.7	85.0	121.0	329.0	153.3	713	2.000			S16PEET125125
<sup>1</sup> *160	110	199.4	31.0	89.0	138.4	24.7	83.9	134.0	376.0	189.4	713	3.100			S16PEET160110
<sup>1</sup> *160	125	199.4	31.0	89.0	153.8	24.7	83.9	134.0	376.0	194.4	813	3.200			S16PEET160125
<sup>1</sup> *160	160	199.4	31.0	89.0	199.4	31.0	89.0	134.0	376.0	183.0	813	3.600			S16PEET160160
*200	110	231.9	36.7	93.0	138.4	24.7	83.9	143.0	337.0	229.4	850	3.900			S16PEET200110
*200	125	231.9	36.7	93.0	153.8	24.7	85.0	143.0	337.0	233.3	850	4.000			S16PEET200125
*200	160	231.9	36.7	93.0	199.4	31.0	89.0	143.0	337.0	223.0	850	4.500			S16PEET200160
*200	200	231.9	36.7	93.0	231.9	36.7	93.0	143.0	337.0	260.3	850	5.100			S16PEET200200
*250	110	293.0	56.0	97.0	138.4	24.7	83.9	200.0	320.0	269.4	1040	8.000			S16PEET250110
*250	125	293.0	56.0	97.0	153.8	24.7	85.0	200.0	320.0	273.3	1040	8.100			S16PEET250125
*250	160	293.0	56.0	97.0	199.4	31.0	89.0	200.0	320.0	263.0	1040	8.700			S16PEET250160
*250	200	293.0	56.0	97.0	231.9	36.7	93.0	200.0	320.0	300.3	1040	9.400			S16PEET250200
*250	250	293.0	56.0	97.0	293.0	56.0	97.0	200.0	320.0	387.0	1040	11.800			S16PEET250250
*315	110	363.6	63.0	104.0	138.4	24.7	83.9	200.0	380.0	329.4	1190	13.500			S16PEET315110
*315	125	363.6	63.0	104.0	153.8	24.7	85.0	200.0	380.0	333.3	1190	13.600			S16PEET315125
*315	160	363.6	63.0	104.0	199.4	31.0	89.0	200.0	380.0	323.0	1190	14.200			S16PEET315160
*315	200	363.6	63.0	104.0	231.9	36.7	93.0	200.0	380.0	340.3	1190	14.300			S16PEET315200
*315	250	363.6	63.0	104.0	293.0	56.0	97.0	200.0	380.0	427.0	1190	16.800			S16PEET315250
*315	315	363.6	63.0	104.0	363.6	63.0	104.0	200.0	380.0	443.0	1190	18.800			S16PEET315315
*355	355	406.0	59.0	221.0	406.0	59.0	221.0	280.0	360.0	395.0	1310	27.200			S16PEET355355
*400	400	433.9	71.0	118.0	433.9	71.0	118.0	280.0	370.0	496.0	1330	37.300			S16PEET400400

Autres dimensions sur demande

Valeurs indicatives, informatives et non contractuelles.